



RGBW COLOR CHANGING MOOD LIGHTING FOR CAR WASHES

Product Features

Engineered for Car Wash - Designed specifically for car wash applications with best in industry IP68 waterproof rating and extreme chemical resistance. Lightweight, low-profile and easy to mount to ceilings, walls, arches and equipment.

Powerful Light Shows - Create an unrivaled customer experience with impactful light shows that actively attract and retain new business.

Synchronized Lighting - Sync all of your tunnel and arch lighting together with a single controller to create vivid, cohesive light shows. See G&G's DMX Tunnel Lighting Controller for additional details.

Plug & Play Wiring & Control System - Patented plug & play wiring and control system for a simple, fast and professional installation.

Performance Summary

Power

Up to 200W

Mounting

Surface (Ceiling, Wall or Arch); 45° Wall Mount Option Available

Dimensions

Lengths 4' & 8' x Width 3" x Height 4"

Voltage

120-277 VAC Input

Secondary Optics

RGB version available with an added narrow 40° optic for arch and equipment lighting

Ordering Information

Product	Length	Light Source	Optics	Through Wired
DMX				
	8 8-Foot	RGBW* RGB + White (5000K) *Recommended for wall and ceiling lighting	Blank No secondary optics 120° beam angle	Blank (Daisy Chain) Through wired with connectors on input & output for ability to daisy chain fixtures. No DMX terminating resistor.
	4 4-Foot	RGB* RGB only *Recommended for arch and equipment lighting	NRW (narrow)* Added narrow optics 40° beam angle *Only available in RGB version	SE (single-end) Connectors on input only, no daisy chain. For standalone install or last fixture in chain. Includes DMX terminating resistor.

Connection Cabling & Mounting

Cable	Type	Length	Wire	Mounting	Description
DMX-JMP-1-5P	Jumper	1ft	18 AWG SJTW		Mounting Kits Must Be Ordered Separately
DMX-JMP-4-5P	Jumper	4ft	18 AWG SJTW	DMX-MNT-SM	Surface Mount Kit - Includes (2) Stainless Steel Band Mounts
DMX-JMP-8-5P	Jumper	8ft	18 AWG SJTW	DMX-MNT-WM	Wall Mount Kit - Includes (2) Stainless Steel 45-Degree Angle Band Mounts
DMX-JMP-20-5P	Jumper	20ft	18 AWG SJTW		
DMX-LDR-25-5P	Leader Cable	25ft	18 AWG SJTW		
DMX-LDR-75-5P	Leader Cable	75ft	18 AWG SJTW		
DMX-LDR-150-5P	Leader Cable	150ft	18 AWG SJTW		



Wall Mount

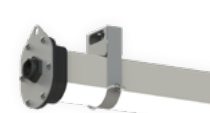

Surface Mount

RGBW COLOR CHANGING MOOD LIGHTING FOR CAR WASHES

Product Specifications

Construction & Materials

Convenient push-and-click connectors let you easily and rapidly install Leader Cables and Jumper Cables. Multiple cable lengths support a variety of layouts.

Integrated aluminum heat spreader.

Seamless polymeric outer shell provides IP68 ingress protection and is specialized for superior chemical resistance.

All G&G luminaires and components (with the exception of our LED boards and drivers) are proudly manufactured and assembled in the USA.

Regulatory Qualifications

cULus Listed

UL Listed for Wet Locations

NEMA 4X Rated

Dimensions

DMX4

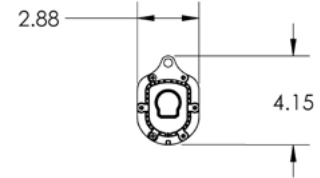

DMX8

