



## Beta Radiation-Resistant Low-Profile LED Linear Luminaire

### Zero-Maintenance Driverless Design

Connects directly to AC line voltage without an LED driver or electrolytic capacitors, for extreme reliability and lifetime.

### Beta Radiation-Resistant Construction

Radiation-resistant technologies leveraging Gallium Nitride (GaN) avoid the use of traditional silicon semiconductor devices like MOSFETs, which are vulnerable to radiation damage. Instead, they utilize advanced materials with high threshold displacement energy, such as GaN and Silicon Carbide (SiC), ensuring superior durability and performance in high-radiation environments.

### Compact, Low-Profile, Round Design

The patented linear housing provides a slim, low-profile allowing installation in almost any application. The design is lightweight, incredibly easy to mount and creates modern, sleek result.

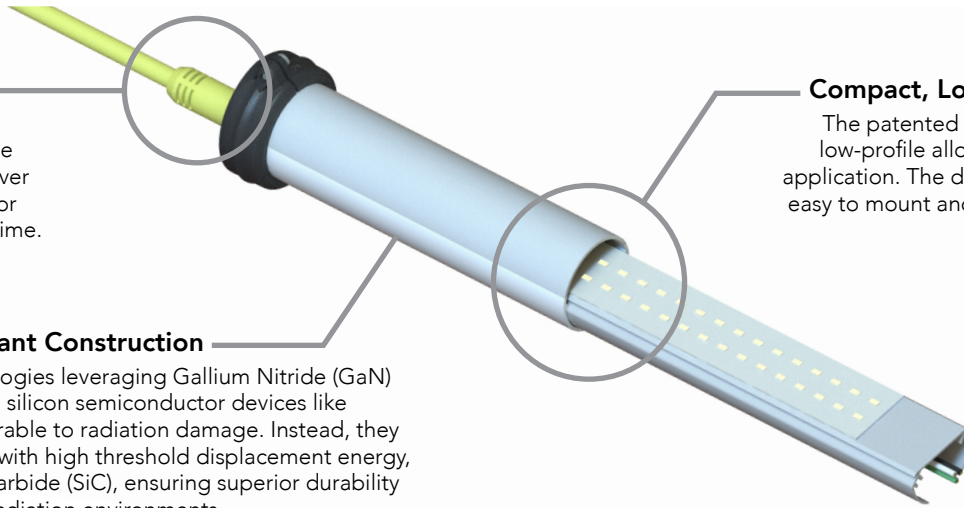

## PERFORMANCE SUMMARY

Total Dose: 500 kGy Beta TID

Delivered Light Output: RRX4 = 5,000 lumens  
RRX8 = 10,000 lumens

Efficacy: Up to 120 LPW

CRI: 80 CRI minimum

CCT: 5000K (Contact factory for custom CCT)

Warranty: 1 Year

Mounting: Ceiling or wall

Lens: Diffused (standard)

IP Protection Class: IP66, IP67

Temperature Rating: Operable in temperatures -40°C to 40°C

Voltage: 120 or 277 VAC Input

Power Factor: 0.9 nominal

Surge Protection: Built-in 4KV

## FIXTURE SPECIFICATIONS

### Construction & Materials

- Proudly engineered and manufactured in America:
  - Buy American Act (BAA) compliant
  - Build America, Buy America Act (BABAA) compliant
- Constructed with non-ferrous materials
- Patented coextruded copolyester and aluminum housing
  - Seamless polymeric outer shell
  - Integrated aluminum heat spreader

### Regulatory Qualifications

- cULus Listed
- UL Listed for wet locations
- IP66/67 Certified
- IK10 Impact Certified
- NEMA 4X Rated

## ORDERING INFORMATION

Product	Length	Color Temp.	Voltage	Wiring Options
<b>RRX</b>		<b>50K</b>		
<b>4</b> 4-Foot		<b>50K</b> (standard) 5000 Kelvin	<b>120V</b> 120 VAC Input	<b>3P</b> (Standard, Single-Ended) Connector on Input Only, for Standalone Install, No Daisy Chain
<b>8</b> 8-Foot		*Contact factory for custom CCT	<b>277V</b> 277 VAC Input	<b>3P-Thru</b> Connectors on Input and Output for ability to Daisy Chain fixtures

## MOUNTING

A stainless steel both latch kit comes included with each fixture.

Mounting Kit	Description
MNT-G3-SURF-SS	Stainless Steel Bolt Latch Mounting Clips

## FIXTURE DIMENSIONS

Model	Length	Width	Height Mounted
RRX4	47.75"	2"	2.25"
RRX8	94.25"	2"	2.25"

## CABLING

Leader required; Jumper for THRU options.

Cable	Type	Wire	End-to-end Length	Fixture-to-fixture Length
RRX-LDR-6-3P	Leader	3 Pole, 16 AWG, Yellow	6'	-
RRX-JMP-1-3P	Jumper	3 Pole, 16 AWG, Yellow	12.625"	11.875"
RRX-JMP-3-3P	Jumper	3 Pole, 16 AWG, Yellow	37.5"	36.75"
RRX-JMP-6-3P	Jumper	3 Pole, 16 AWG, Yellow	74.125"	73.375"

## DIMENSIONAL DRAWINGS

### RRX4

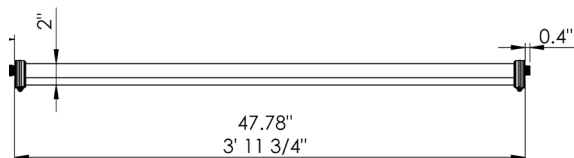

### End cap

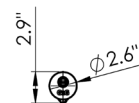

### RRX8

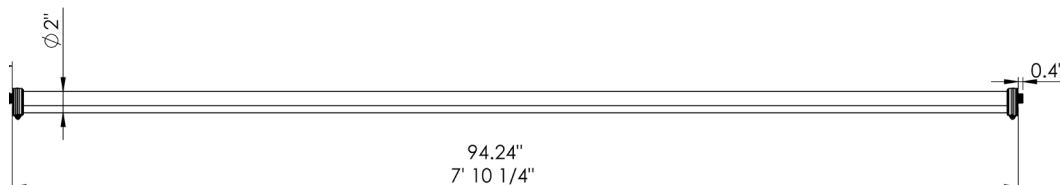

## PHOTOMETRY

### Polar Candela Distribution

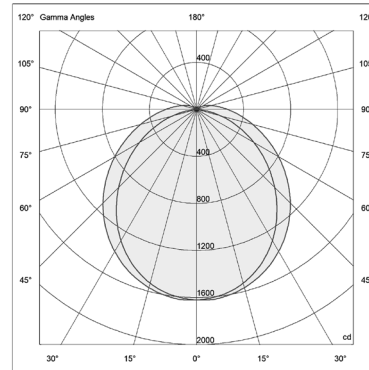

### Zonal Lumen Summary

Zone	Luminaire
0-30	24.8%
0-40	40.4%
0-60	70.7%
0-90	94.9%
0-180	100%

## LUMEN & POWER DATA

Length & Output	Lumens	Wattage	Amps @ 120V	Amps @ 277V
RRX4	5,000	41	0.35	0.15
RRX8	10,000	82	0.70	0.30