



**IP67**  
CERTIFIED



**DIRECT AC**  
**DRIVERLESS**



Proudly made  
in America



## Bendable LED Linear Luminaire for Vacuum Arch Lighting

### Zero-Maintenance Driverless Design

Connects directly to AC line voltage without an LED driver or electrolytic capacitors, for extreme reliability and lifetime.

### Coextruded Copolyester/Aluminum Housing

Our patented process combines copolyester and aluminum together, with no seals or gaskets. The result is a single piece enclosure with excellent heatsinking characteristics for a long lifetime and reliability.

### Superior Chemical & UV Resistance

Seamless polymeric outer shell provides IP67 ingress protection and is specialized for superior chemical resistance. Includes an additional protective coating which integrates a UV blocker for outdoor applications.

### Easy to Install & Bend for Vac Arches

Convenient push-and-screw connector makes VAC series fixtures easy to install and bendable housing allows easy forming to radius of vac arch.

### Compact, High Output LEDs

Remarkably slim, low-profile one-inch design, that packs a punch at up to 4,800 lumens.

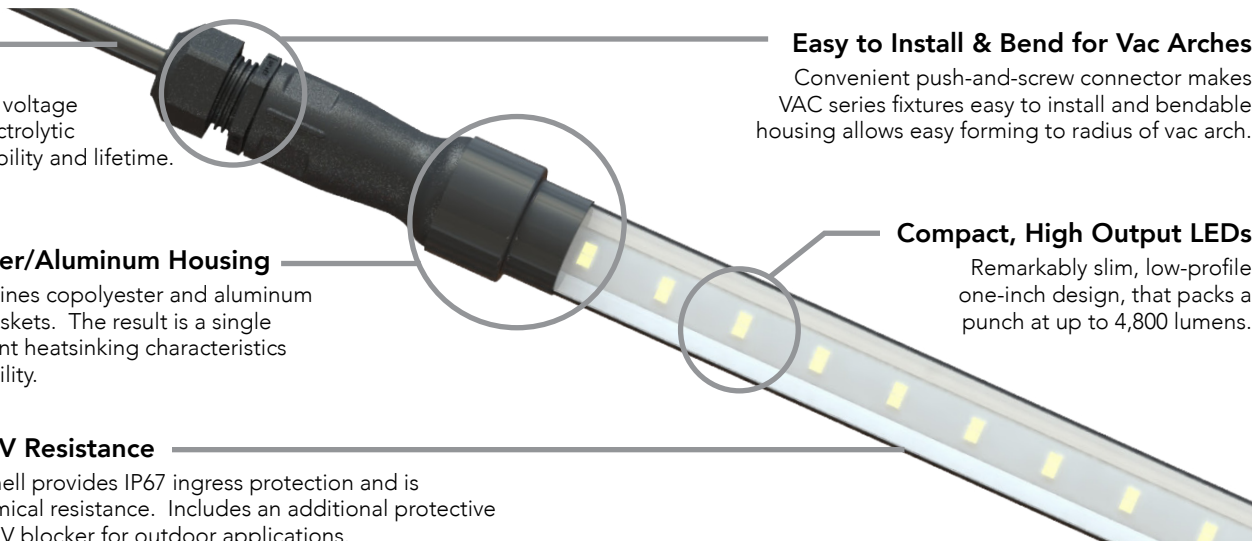

## PERFORMANCE SUMMARY

Delivered Light Output: Up to 4,800 Lumens

Efficacy: Up to 130 LPW

CRI: Typical 85 CRI

CCT: 5000K & 4000K (Contact factory for custom CCT)

Lifetime: 100,000 Hours at 25°C

Warranty: 5 Years

Lens: Clear

Protection Class: IP67

Temperature Rating: Operable in temperatures -40°C to 55°C

Voltage: 120 or 277 VAC Input

Power Factor: 0.9 nominal

Surge Protection: Built-in 4KV

Total Harmonic Distortion: < 20%

## FIXTURE SPECIFICATIONS

### Construction & Materials

- Proudly American-made and Buy America Act compliant
- Hand bendable to form to radius of vacuum arch
- Patented coextruded copolyester and aluminum housing
  - Seamless polymeric outer shell
  - Integrated aluminum heat spreader
- Double insulated (cabling and fixture)

### Regulatory Qualifications

- cULus Listed
- UL Listed for Wet Locations
- IP67 Certified
- NEMA 4X Rated

## ORDERING INFORMATION

Product	Length	Color Temp.	UV Protection	Voltage
<b>VAC</b>			<b>UVO</b>	
<b>4</b> 4-Foot	<b>50K</b> (standard) 5000 Kelvin	<b>UVO</b> (standard) Outdoor-Rated with UV-Blocking Coating	<b>120V</b> 120 VAC Input	
<b>6</b> 6-Foot	<b>40K</b> 4000 Kelvin		<b>277V</b> 277 VAC Input	
<b>8</b> 8-Foot				

## MOUNTING

A non-metallic quick latch kit comes included with each fixture.

Part Number	Description
MNT-G1-NM-2020	Non-Metallic Quick Latch Mounting Clips (UVO Outdoor)
MNT-G1-SS	Stainless Steel Bolt Latch Mounting Clips

## CABLING

All models come with 15' SJTOOW power cord.

## LUMEN & POWER DATA

Length & Output	Lumens	Wattage	Amps @ 120V	Amps @ 277V
VAC4	2,400	18	0.150	0.065
VAC6	3,600	27	0.225	0.097
VAC8	4,800	36	0.300	0.130

## PHOTOMETRY

### VAC Series

Based on DTC Report Test #: 14404-T

Fixture photometry has been conducted by a NVLAP accredited testing laboratory in accordance with IESNA LM-79-08. IESNA LM-79-08 specifies the entire luminaire as the source resulting in a fixture efficiency of 100%.

### Polar Candela Distribution

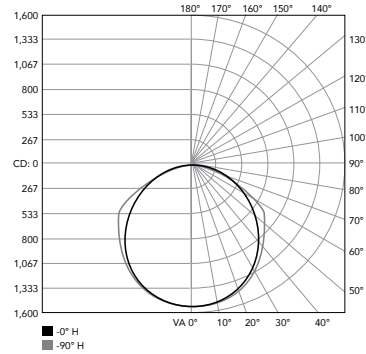

### Zonal Lumen Summary

Zone	Luminaire
0-30	26.2%
0-40	43.2%
0-60	77.4%
0-90	98.5%
0-180	100%

## FIXTURE DIMENSIONS

Model	Length	Width	Height Mounted
VAC4	47.56"	1.25"	1.75"
VAC6	69.56"	1.25"	1.75"
VAC8	91.56"	1.25"	1.75"

## DIMENSIONAL DRAWINGS

### VAC4

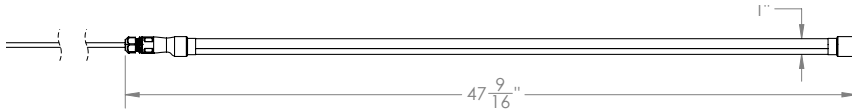

### VAC6

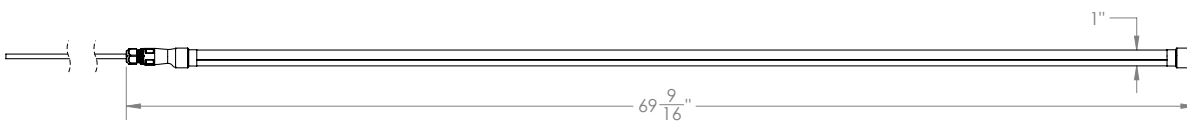

### VAC8

